

| LOW PROFILE, 240V, 50HZ,<br>SERVICE PARTS LIST |                         | MODEL NUMBER |              | 24377        | 24372                  |
|--|-------------------------|--------------|--------------|--------------|------------------------|
|  |                         | FINISH       |              | WHITE -132   | BRUSHED<br>NICKEL -214 |
| ITEM NO  | DESCRIPTION             | QTY          |              |              |                        |
| 1  | HANGER PLATE ASSEMBLY   | 1            | 87213-01-232 | 87213-01-232 |                        |
| 2  | MOTOR ASSEMBLY          | 1            | 96878-01-132 | 96878-02-214 |                        |
| 3  | HOUSING                 | 1            | 92511-02-132 | 92511-02-214 |                        |
| 4  | SWITCH HOUSING ASSEMBLY | 1            | 87772-01-132 | 87772-02-214 |                        |
| (B) (A) 5                                      | BLADE SET               | 1            | 76238-07-000 | 76238-08-000 |                        |
| (B) (A) 6                                      | BLADE IRON SET          | 1            | 97212-05-132 | 97212-05-214 |                        |
| (B) 7  | MEDALLION SET           | 1            | 87734-05-132 | 87734-05-214 |                        |
| 8  | HARDWARE KIT            | 1            | 87217-03-000 | 87217-04-000 |                        |
| (B) 9  | WIRE HARNESS            | 1            | 76060-09-000 | 76060-10-000 |                        |

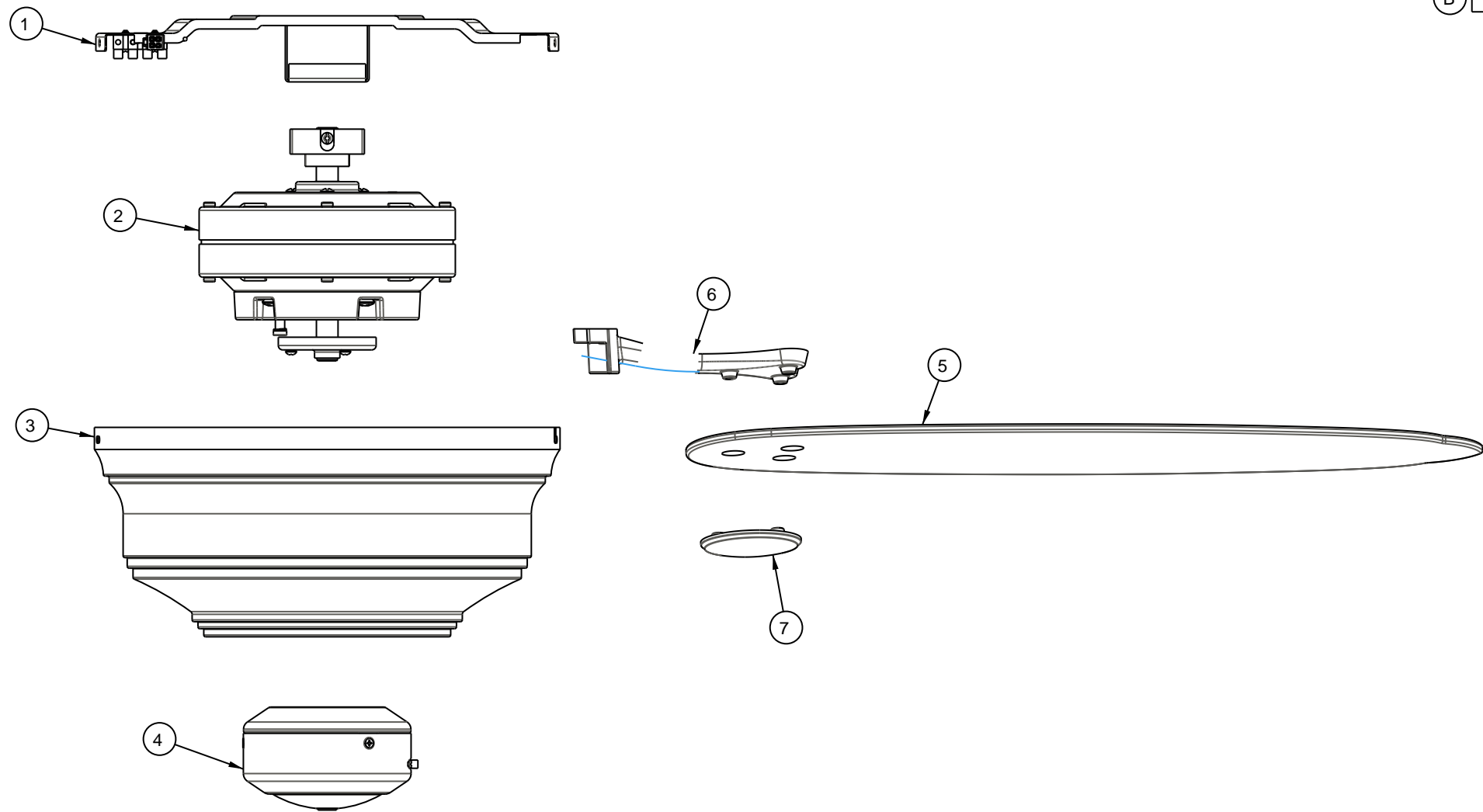

(8) NOT SHOWN

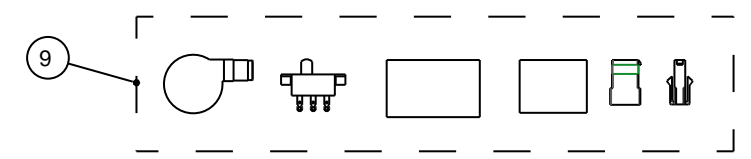

| B   | GROUP O2 FINISH 214 WAS 306. BLADE SET 76238 WAS 75885. BLADE IRON SET 97212 WAS 92523. ADDED MEDALLION AND WIRE HARNESS. | KL |     |     | 8578 | 4/12/07 |
|-----|---|----|-----|-----|------|---------|
| A   | BLADE IRON SET 92523 WAS 93724. BLADE SET 75885 WAS 75006.  | KL | --- | --- | 8578 | 3/31/06 |
| REV | DESCRIPTION   | BY | CK  | APP | ECN# | DATE    |



**HUNTER FAN COMPANY**  
2500 FRISCO AVE., MEMPHIS, TENN. 38114

|  |  |                                |                                 |
|--|--|--------------------------------|---------------------------------|
| <b>CONFIDENTIAL</b>  |  | DOC NUMBER<br>8578             | STATUS<br>ACTIVE                |
| THIS DOCUMENT AND THE INFORMATION IT DISCLOSES IS THE EXCLUSIVE PROPERTY OF HUNTER FAN COMPANY. ANY REPRODUCTION OR USE OF THIS DRAWING, IN PART OR IN WHOLE, WITHOUT THE EXPRESS CONSENT OF THE PROPRIETOR IS PROHIBITED. |  | TYPE CODE<br>55                | DATE (MM-DD-YYYY)<br>3/13/06    |
| SHEET SIZE<br><b>B</b>   | THIRD ANGLE PROJECTION<br>                       | CHECKED BY<br>MODELED BY<br>KL | MATERIAL<br>FINISH<br>SEE CHART |
| MODEL TYPE<br>ASSEM  | FIRST USE  | DRAWING BY<br>KL               | MODEL NUMBER<br>96878           |
| SCALE<br>1:4   | DESCRIPTION<br>FINAL ASM, LOW PROFILE, 240V 50HZ | REL LEVEL<br>Detail            | REVISION<br>B                   |
| SHEET<br>1 OF 1  |  | DRAWING NUMBER<br><b>75934</b> | REVISION<br>B                   |
|  |  | REL LEVEL<br>Detail            |                                 |