

LEMDYNE		MODEL NUMBER	24098	24095	24091	24093
PARTS GUIDE		FINISH	ATLANTIC BLUE	ARCH. WHITE	BRUSHED NICKEL	BRUSHED NICKEL
ITEM NO	DESCRIPTION	QTY	PART NUMBERS			
1	ASM, TRI-LOBE HANG SYSTEM	1	94697-12-278	94697-10-274	94697-06-214	94697-06-214
2	MOTOR HOUSING ASSEMBLY	1	93805-01-278	93805-01-274	93805-01-214	93805-01-214
3	SERVICE HARDWARE KIT	1	85377-01-278	85377-02-274	85377-03-214	85377-03-214
4	BLADE SET	1	74296-47-000	74296-46-000	74296-61-000	74296-61-000
5	BLADE IRON SET	1	74417-20-314	74417-20-314	74417-10-214	74417-10-214
6	DOWNROD 12"	1	-----	-----	-----	74228-21-214
7	RF REMOTE CONTROL ACCESSORY	1	-----	-----	-----	24756

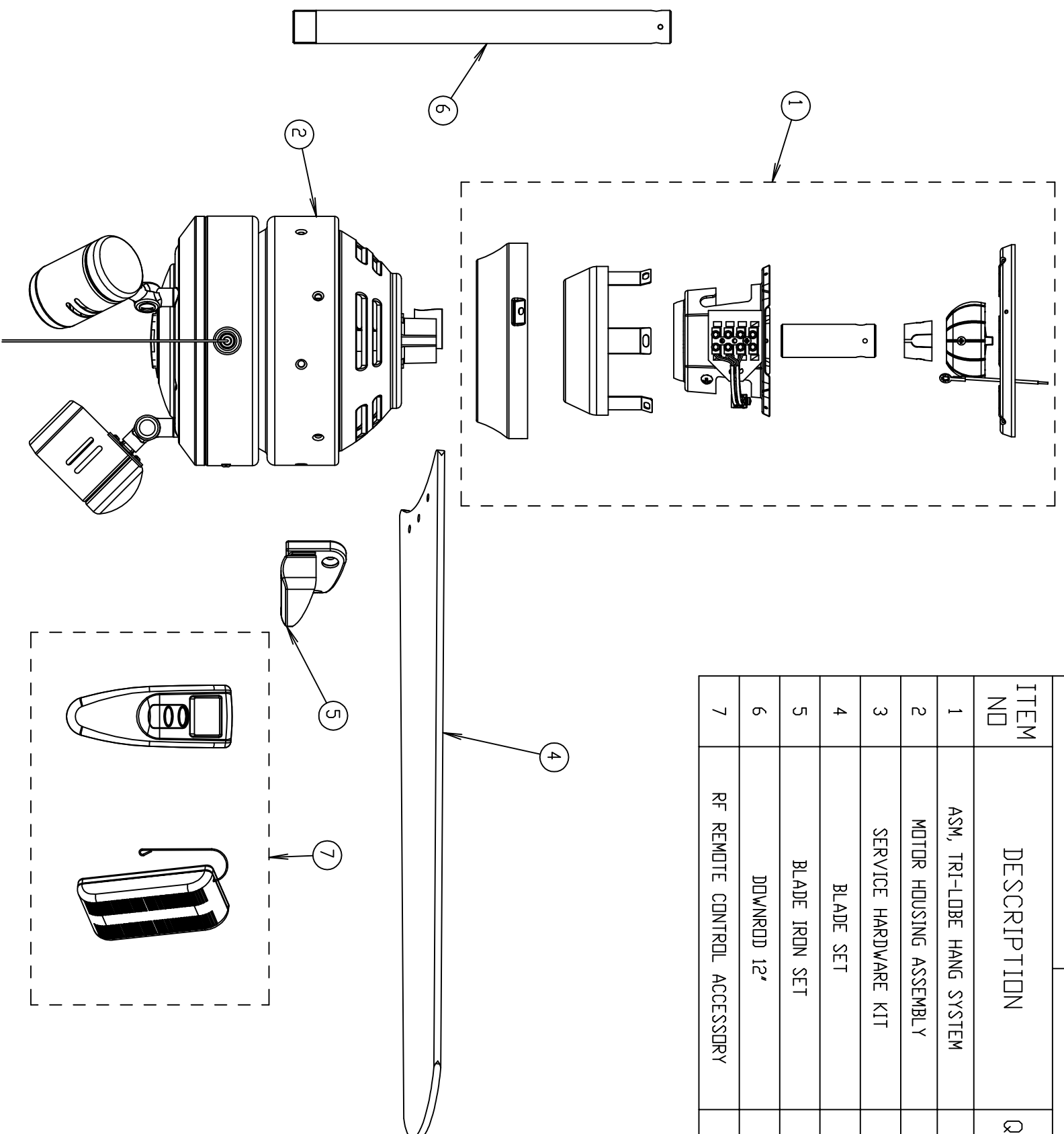

REV.	DESCRIPTION	BY:	CHK:	APP:	ECN NO.	DATE
D	REMOTE CONTROL 24756 WAS 24796.	KL			8358	8/9/06
C	REVISED REMOTE ACCESSORY	TEB			7028	1/2/04
B	REVISED HANG SYSTEM KIT, ADDED 24093	TEB			6972	12-12-03
A	ITEM NO 3 ON 24058 WAS 93085-01-278	TEB			6658	9-11-02

CONFIDENTIAL



HUNTER FAN COMPANY
2500 FRISCO AVE., MEMPHIS, TENN. 38114

THIS DOCUMENT AND THE INFORMATION IT DISCLOSES IS THE EXCLUSIVE PROPERTY OF HUNTER FAN COMPANY. ANY REPRODUCTION OR USE OF THIS DRAWING, IN PART OR IN WHOLE, WITHOUT THE EXPRESS CONSENT OF THE PROPRIETOR ARE PROHIBITED.

TOLERANCES: (UNLESS OTHERWISE SPECIFIED)
DECIMAL: ±.01
XX = ±.005
XXX = ±.005
FRACTIONAL: ±1/64
ANGULAR: ±5°

DATE:	DRAWN BY:	TEB	DEPARTMENTAL APPROVALS
8/12/02	TEB		
SCALE: 1/4	CHECKED BY:	R & D:	QA:
FIRST USE: LEMDYNE	ENG:		MFG:
REFERENCE: PJD-6634	MKTG:		ID:
PART NAME: SERVICE PARTS GUIDE	PART NO.:		74728

FOR SERVICE PARTS
USE ONLY!