

ITEM NO	DESCRIPTION	QTY	CARRERA			
			MODEL NUMBER	FINISH	ARCH.	BRUSHED NICKEL
1	ASM, LOWER CANOPY, CONTEMP.	1	85355-01-116	85355-01-274	85355-01-214	85355-01-271
2	ASM, TRI-LOBE HANG SYSTEM	1	94125-03-116	94125-24-274	94125-03-214	94125-03-271
3	MOTOR HOUSING ASSEMBLY	1	93817-01-116	93817-02-274	93817-03-214	93817-04-271
4	UPPER CANOPY, INT.	1	85255-01-116	85255-01-274	85255-01-214	85255-01-271
5	SERVICE HARDWARE KIT	1	85353-01-000	85353-02-000	85353-03-000	85353-04-000
6	BLADE SET	1	74438-32-000	74438-33-000	74438-46-000	76238-32-000
7	BLADE IRON SET	1	93104-03-116	93104-02-274	93104-03-214	93104-03-271

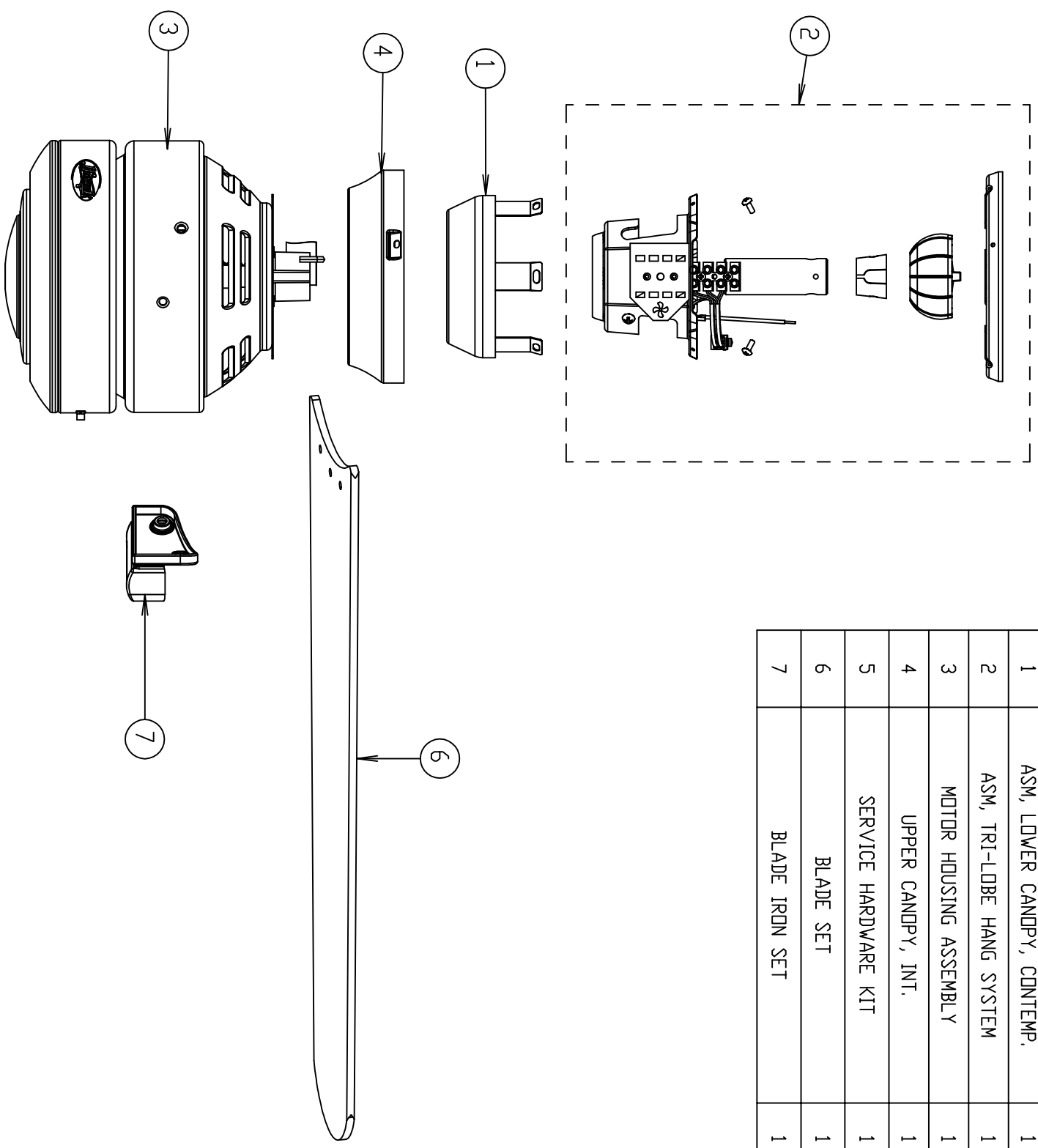

REV.	DESCRIPTION	BY:	CK:	APP:	ECON #	DATE
A	ADDED MODEL 24241, BLADE IRON SET 93104-03 WAS 74417.	KL			8935	8/17/07

CONFIDENTIAL

HUNTER FAN COMPANY
 2500 FRISCO AVE., MEMPHIS, TENN. 38114
 SINCE 1886

THIS DOCUMENT AND THE INFORMATION IT DISCLOSES IS THE EXCLUSIVE PROPERTY OF HUNTER FAN COMPANY. ANY REPRODUCTION OR USE OF THIS DRAWING, IN PART OR IN WHOLE, WITHOUT THE EXPRESS CONSENT OF THE PROPRIETOR ARE PROHIBITED.

TOLERANCES: (UNLESS OTHERWISE SPECIFIED)
 DECIMAL: ±.01
 .XX = ±.005
 .XXX = ±.005
 FRACTIONAL: ±1/64
 ANGULAR: ±5°

DATE: 8/12/02	DRAWN BY: TEB	DEPARTMENTAL APPROVALS
SCALE: 1/4	CHECKED BY:	R & D
FIRST USE: CARERA	ENG:	MFG:
REFERENCE: PDF-6634	MKTG:	ID:
PART NAME: SERVICE PARTS GUIDE	PART NO.:	74727

FOR SERVICE PARTS
 USE ONLY!